

VOORAANZICHT - VUE FRONTALE  
VORDERANSICHT - FRONT VIEW

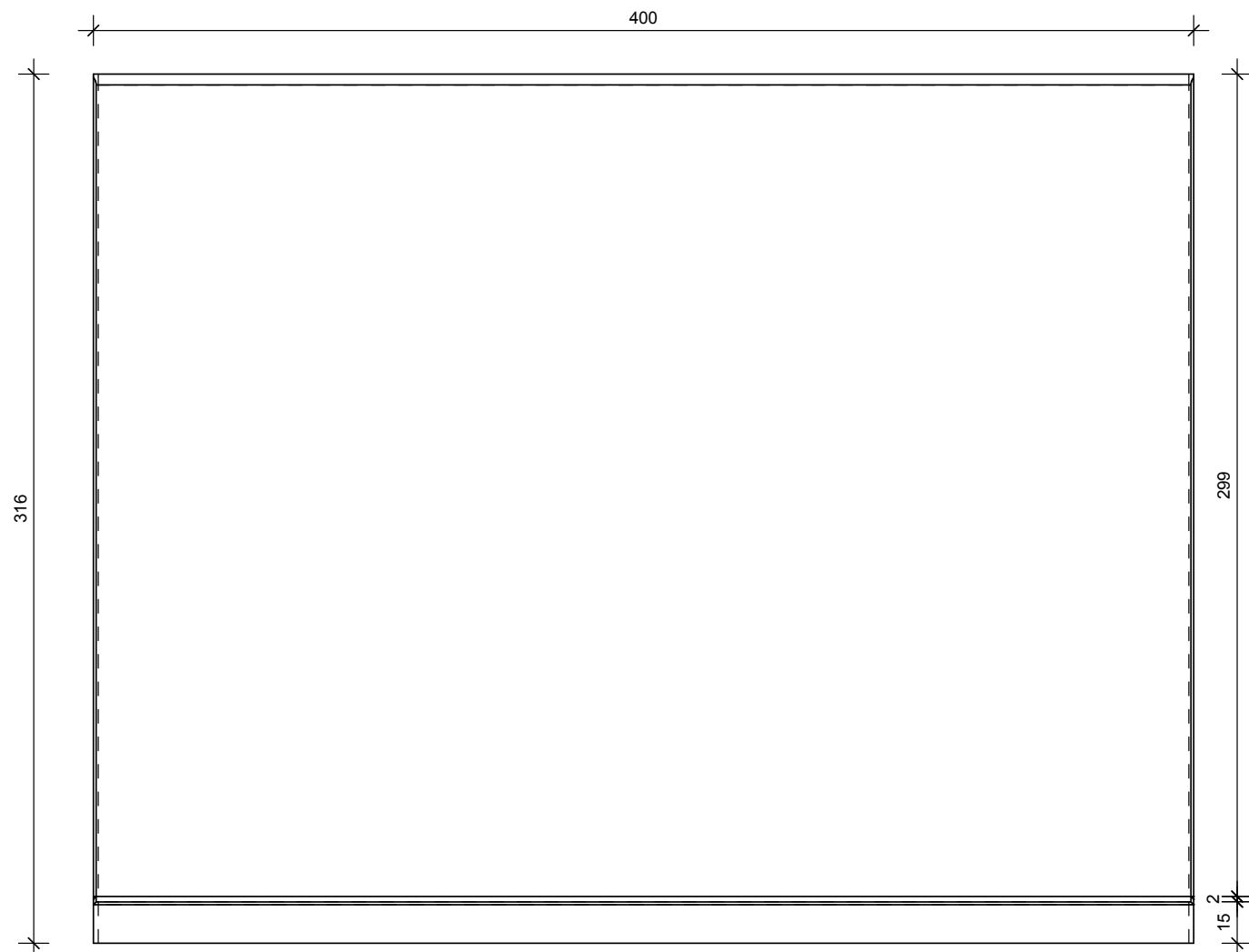

BOVENAANZICHT - VUE SUPERIEURE  
DRAUFSICHT - TOP VIEW

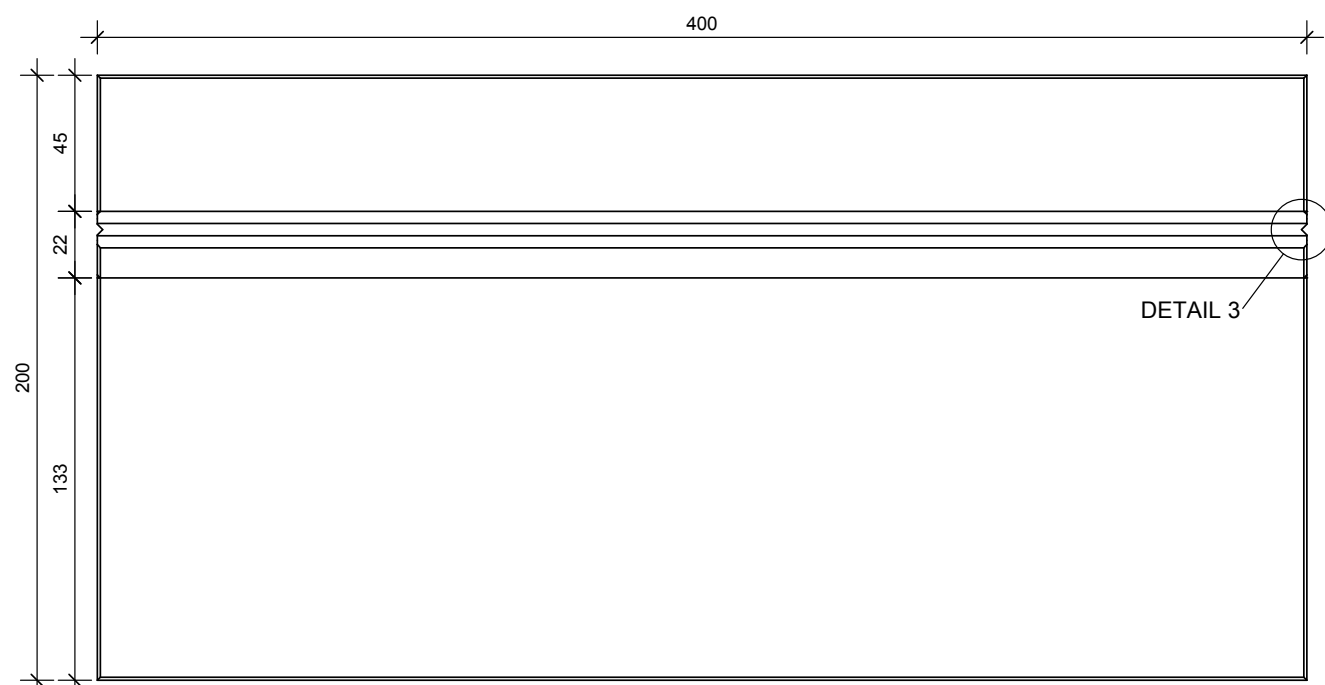

DOORSNEDE - COUPE TRANSVERSALE  
QUERSCHNITT - CROSS SECTION

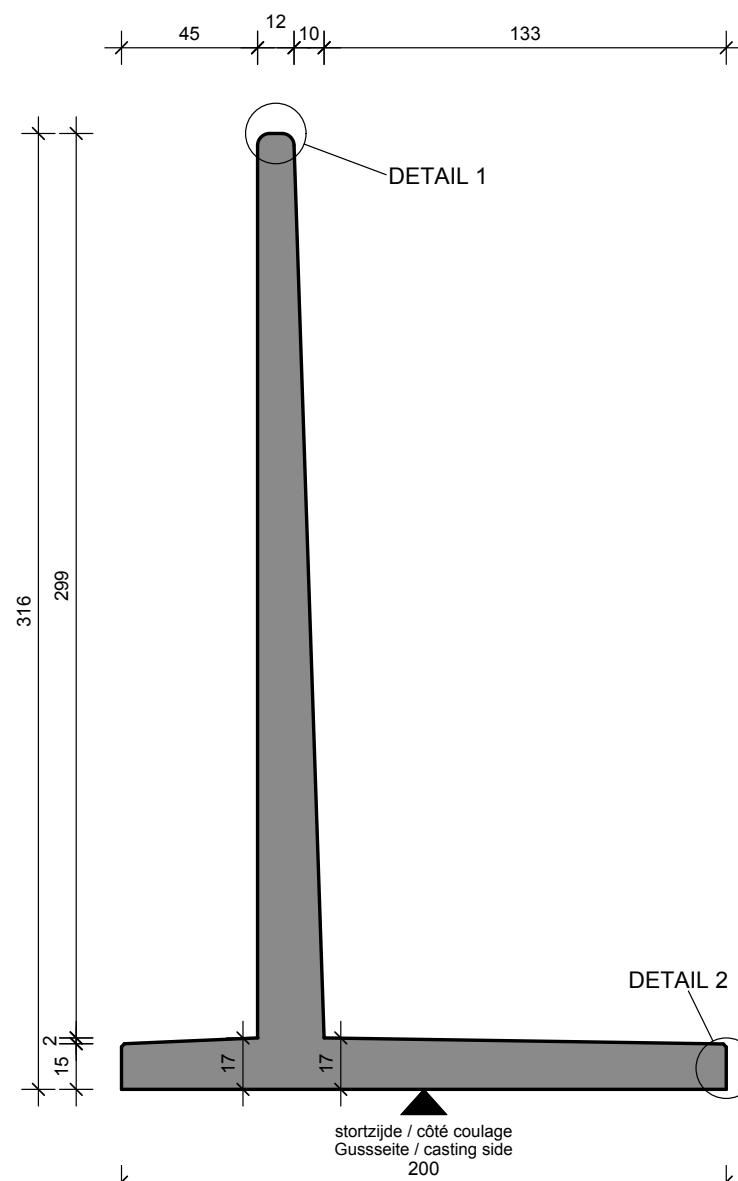

DETAIL 1

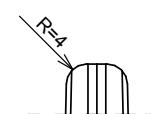

DETAIL 2

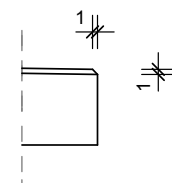

DETAIL 3

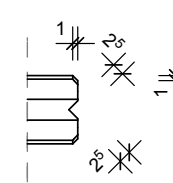

3D

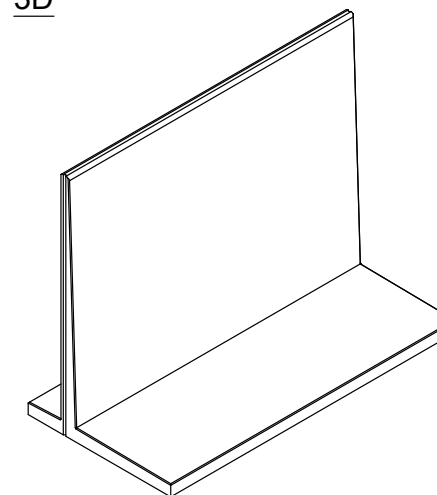

Opmerking:  
Betonmaten in cm. Overige maten in mm.



TECHNISCHE FICHE / FICHE TECHNIQUE  
TECHNISCHE DATEN / TECHNICAL DATA

element / élément / Element / element

CLAGRI 316x400

|   |               |
|---|---------------|
| sterkteklasse / classe de résistance<br>Festigkeitsklasse / strength class                                | C60/75        |
| sterkte bij levering / résistance lors de la livraison<br>Festigkeit bei Lieferung / strength at delivery | /             |
| betondekking / enrobage de béton<br>Betondeckung / concrete cover   | 30mm          |
| milieuklasse / classe d'exposition<br>Expositionsklasse / exposure class<br>(EN 206)                      | XC4, XF1, XA3 |
| constructieklasse / classe structurale<br>structural class  | S1            |
| staalkwaliteit / qualité de l'acier<br>Stahlgüte / steel quality  | B500B         |

|   |                     |
|---|---------------------|
| artikelnr. / numéro d'article<br>Artikelnr. / item number | 11661               |
| versie / version<br>Version / version                     | 20190717            |
| productie / production<br>Herstellung / production        | Emmen / Wielsbeke   |
| volumen / volume<br>Volumen / volume                      | 3.31 m <sup>3</sup> |
| gewicht / poids<br>Gewicht / weight                       | 8000 kg             |
| ankers / ancrés<br>Anker / anchors                        | RTA: /<br>KKA: /    |

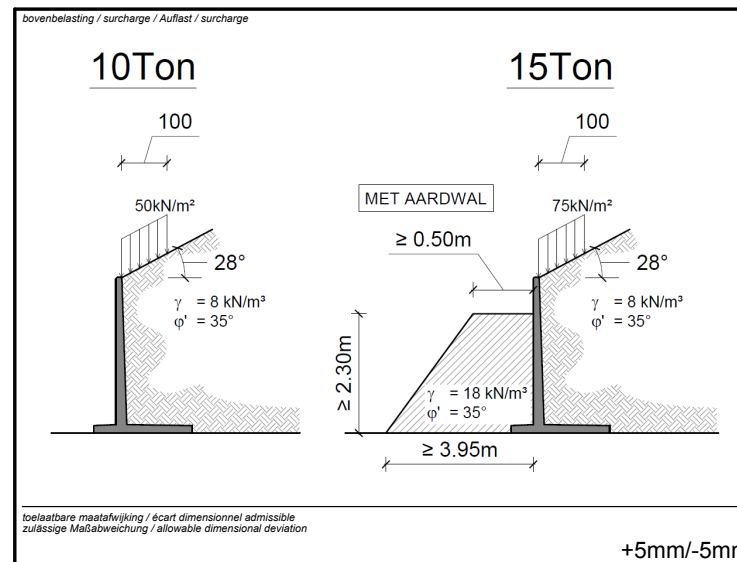

MBS & CBS Beton BV  
Phileas Foggstraat 24D  
NL-7825 AK Emmen

Tel. +31 05 91 742 010

info@mbs-cbsbeton.nl  
www.mbs-cbsbeton.nl